

# STATE OF COLORADO

---

**Department of Higher Education  
COLORADO COMMISSION ON HIGHER EDUCATION**

Peggy Lamm, Chair  
Dean L. Quamme, Vice Chair  
Judith Altenberg  
Raymond T. Baker  
Terrance L. Farina  
David E. Greenberg  
Pres Montoya  
Ralph J. Nagel  
James M. Stewart  
William Vollbracht  
Judy Weaver



---

Bill Owens  
Governor

Timothy E. Foster  
Executive Director

## MEETING ANNOUNCEMENT

On Friday, April 5, 2002, the Colorado Commission on Higher Education will hold its regular meeting at 1:00 p.m. in the Bruns Conference Room, Building 500 at the Fitzsimons Campus of the University of Colorado Health Sciences Center, 12101 E. Colfax, in Aurora, Colorado.

The Colorado Commission on Higher Education permits public discussion of agenda items at each of its regular meetings. Discussion items are designed to provide an opportunity for governing board consultation prior to Commission action.

Prior to the Commission meeting, the Commission members will meet informally for lunch.

If you have questions about the meeting, please call JoAnn Evans at (303) 866-2723.

**MAPS TO FITZSIMONS:** [Map A](#)  
[Map B](#)

**Area map and Fitzsimons campus map**

**Area Map**

Search UCHSC/UCH 

[Fitzsimons Campus map](#)

[For more information about UCHSC/UCH at Fitzsimons](#)

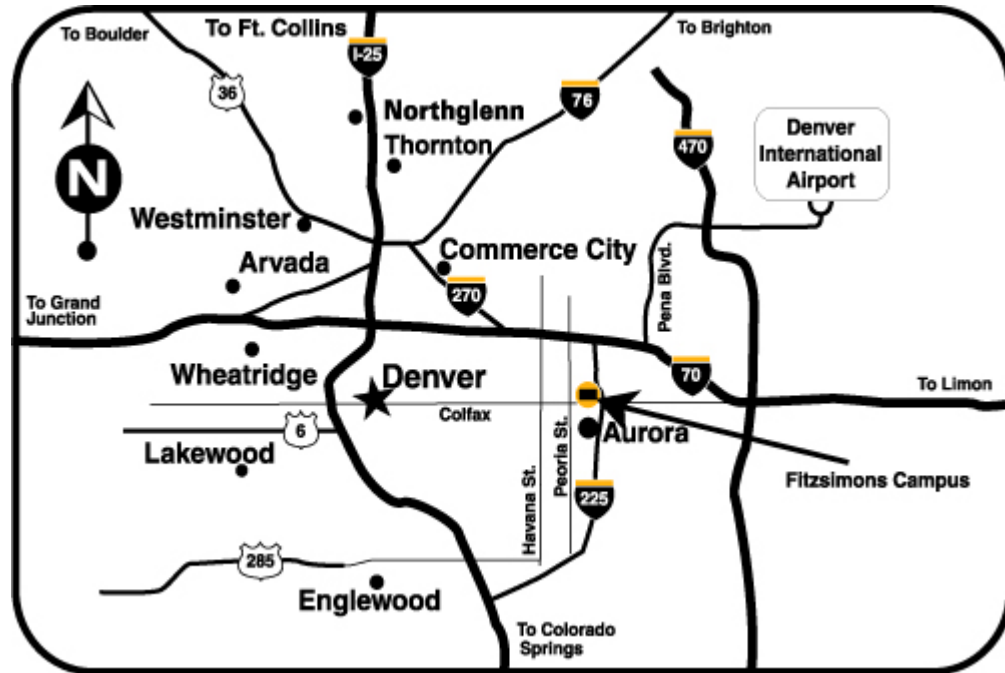

Click here for a printable [area map](#). Requires Adobe Acrobat®

**Fitzsimons Campus Map**

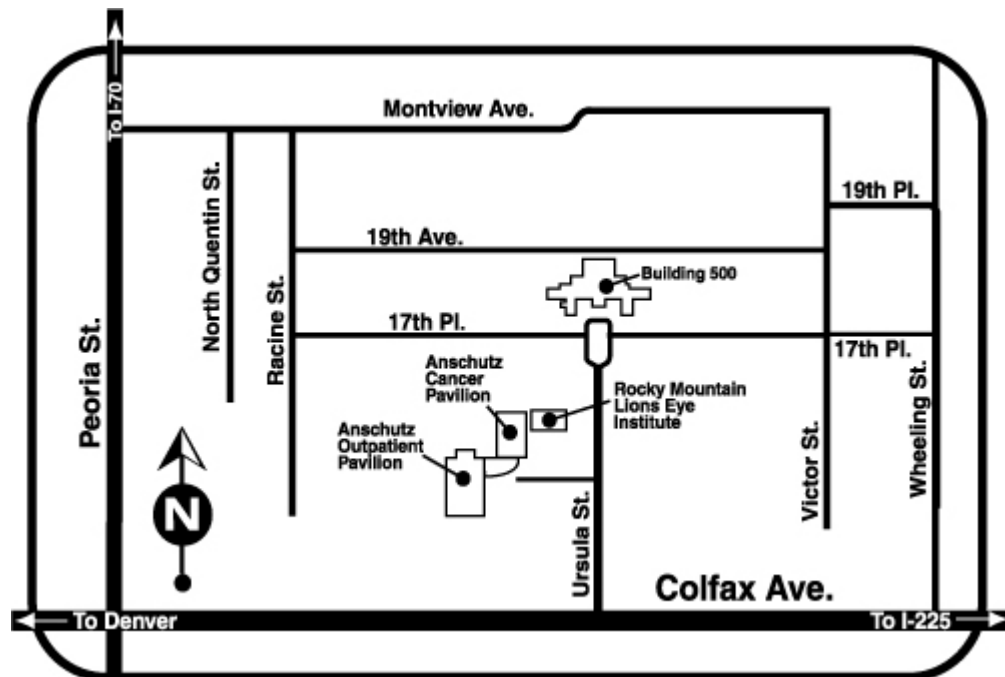

Click here for a printable [campus map](#). Requires Adobe Acrobat®

Search UCHSC/UCH

### Finding UCHSC's Fitzsimons campus

[9th Ave. campus](#)

[Region maps](#)

[Maps home](#)

The street address is:

13001 E. 17th Place  
Aurora, CO 80011

It used to be 12101 E. Colfax, and cab drivers might understand that better.

### Maps

Here is the area around the Fitzsimons campus:

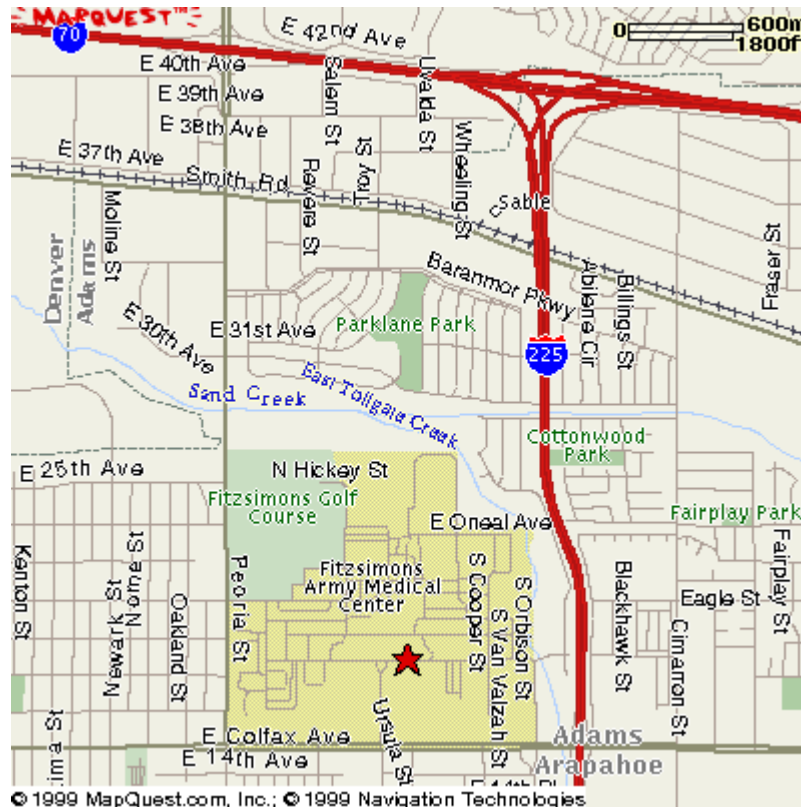

Here is a partial campus map:

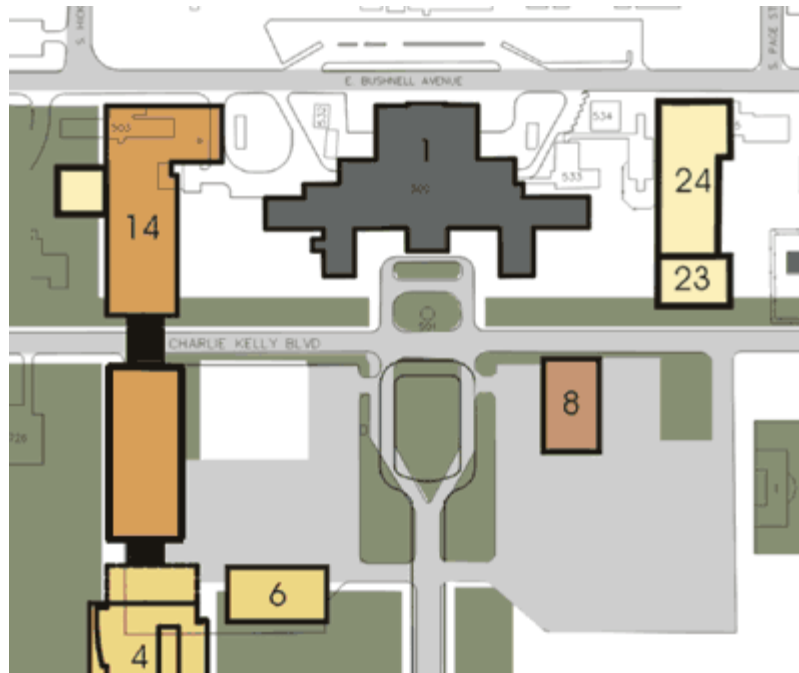

In this map, you enter the campus from the south (bottom), proceed north on Ursula St., and park near where building #8 is to be. The dark shape labeled #1 in the top center of the map is the old hospital building, where most offices are located (the Army called it building 500).

The new Anschutz Center is labeled #4, and #6 is the new Rocky Mountain Lions Eye Institute. Construction has begun on the Nighthorse Campbell Native Health building (#8) and Research Complex One (#14), but not on #23 and #24. The cross street in front of the hospital, labeled Charlie Kelly Blvd here, has been renamed 17th Place.

Here are [more](#) maps of Fitzsimons.

### Directions

The campus is located in the east central part of the metro Denver area near the intersection of I-70 (east-west) and I-225 (a beltway running north-south at this point). The main entrance is north on Ursula St. from Colfax Ave. (which runs east-west). Ursula is between Peoria and I-225.

For the most part, the main hospital building (now office space) is the only currently occupied building on the campus.

#### From downtown

1. Take Colfax east for about 10 miles.
2. Turn left on Ursula Ave, just past Peoria and just before I-225.

#### From the airport

1. Take Pena Blvd south until it runs into I-70.
2. Almost immediately there is a fork (left) to take I-225 south.
3. Take I-225 south about 1 mile to the first exit, Colfax.
4. Go right (west) about 2 blocks to Ursula Ave.
5. Turn right (north) onto the campus.

From the 9th Ave campus

1. Go north on Colorado Blvd to Colfax.
2. Turn right (east) and travel about 5 miles to Ursula Ave.
3. Turn left (north) at Ursula and onto the campus.

From the North

1. Go south on I-25 until the Colfax exit.
2. Turn east (left) onto Colfax and follow it for about 8 miles.
3. Turn left (north) at Ursula and onto the campus.
4. Alternatively, take I-25 to I-70 to I-225 and follow the instructions from the airport (above).

From the South

1. The directions are the same as from the north, except you are headed north on I-25.
2. Alternatively, take I-25 to I-225 to the Colfax exit, turn left (west) and follow the instructions from the airport (above).